



City of Santa Monica. All Rights Reserved



Santa Monica - Malibu Unified School District

Legend

- School
- School District Boundary



Franklin School Map, Directions, and Boundaries

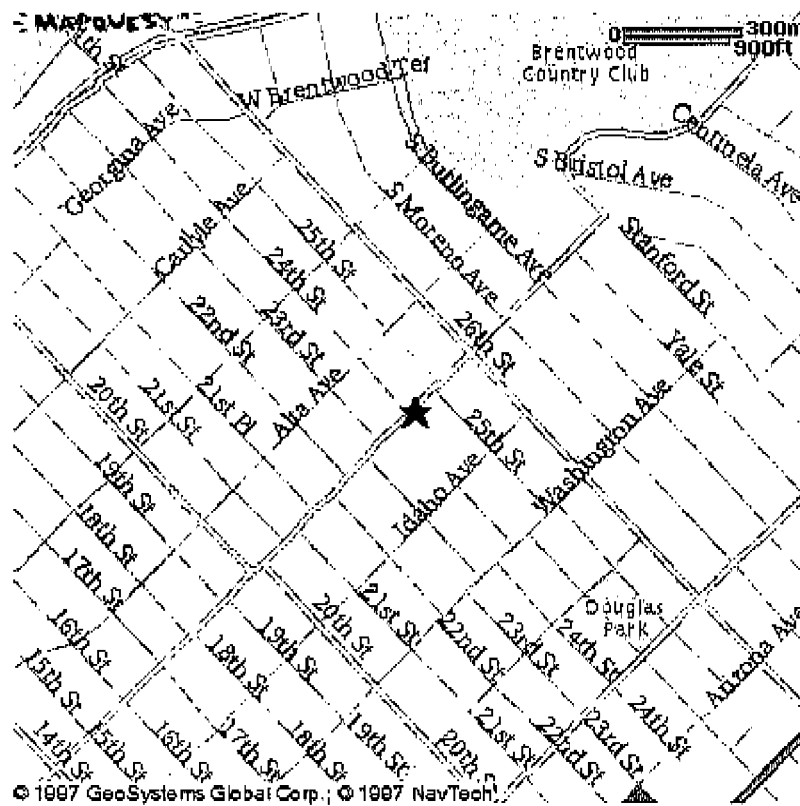

[Click on Map for Directions](#)

ATTENDANCE AREA

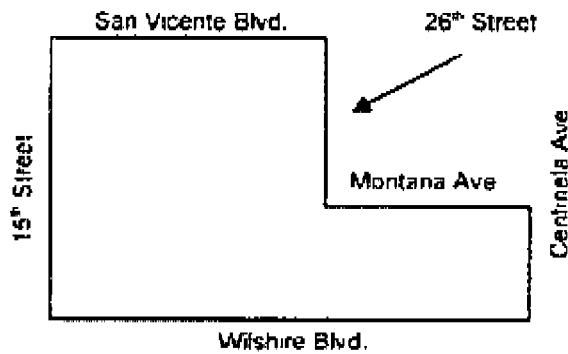

Los Angeles Unified School District

Canyon Elementary School Attendance Area

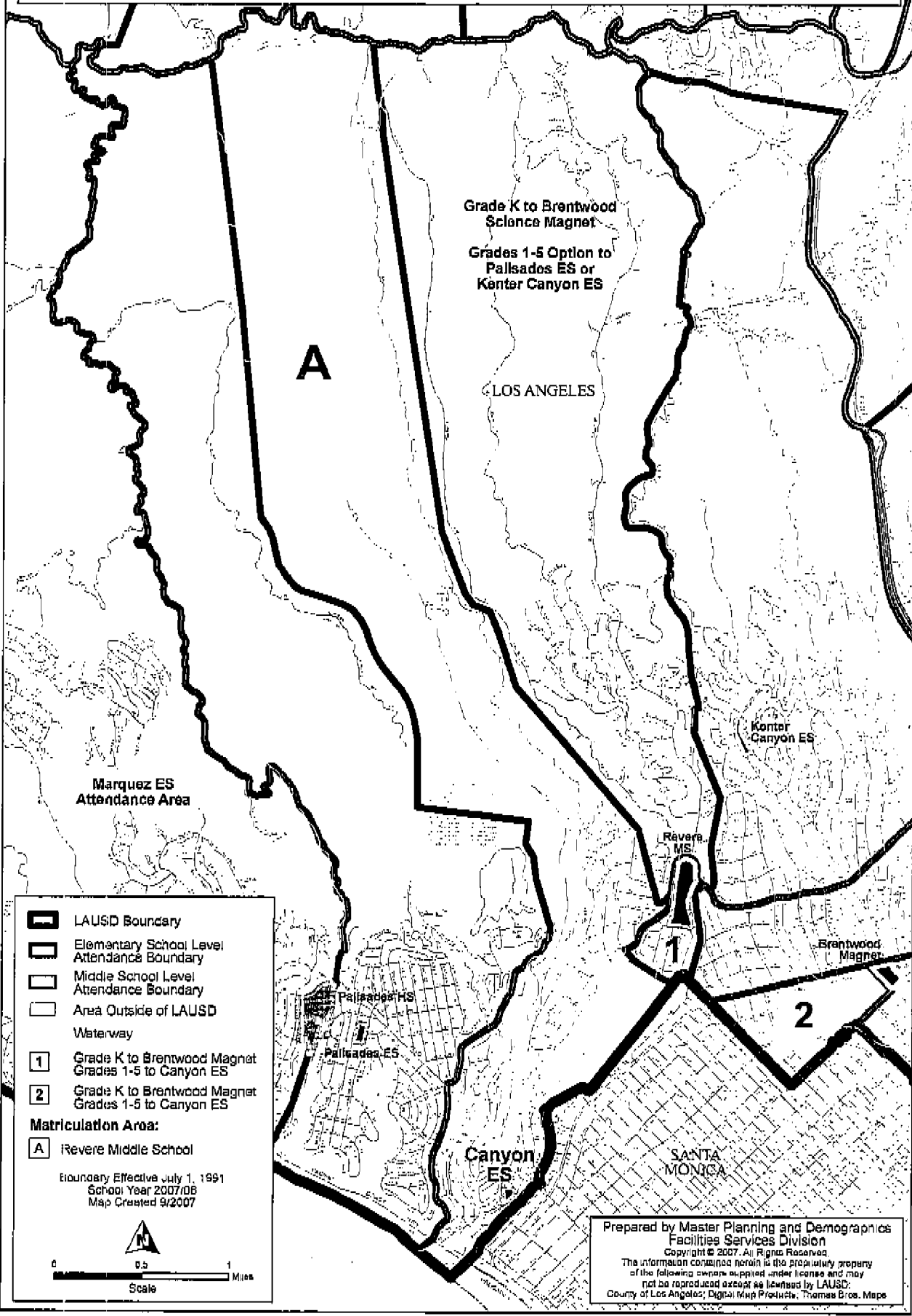

- LAUSD Boundary
- Elementary School Level Attendance Boundary
- Middle School Level Attendance Boundary
- Area Outside of LAUSD
- Waterway
- Grade K to Brentwood Magnet
Grades 1-5 to Canyon ES
- Grade K to Brentwood Magnet
Grades 1-5 to Canyon ES

Matriculation Area:

- Revere Middle School

Boundary Effective July 1, 1991
School Year 2007/08
Map Created 9/2007

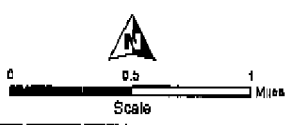

Prepared by Master Planning and Demographics
Facilities Services Division
Copyright © 2007. All Rights Reserved.
The information contained herein is the proprietary property
of the following owners as applied under license and may
not be reproduced or used in any form without the written
consent of Los Angeles Digital Map Products, Thomas Bros. Maps

Los Angeles Unified School District
Kenter Canyon Elementary School Attendance Area

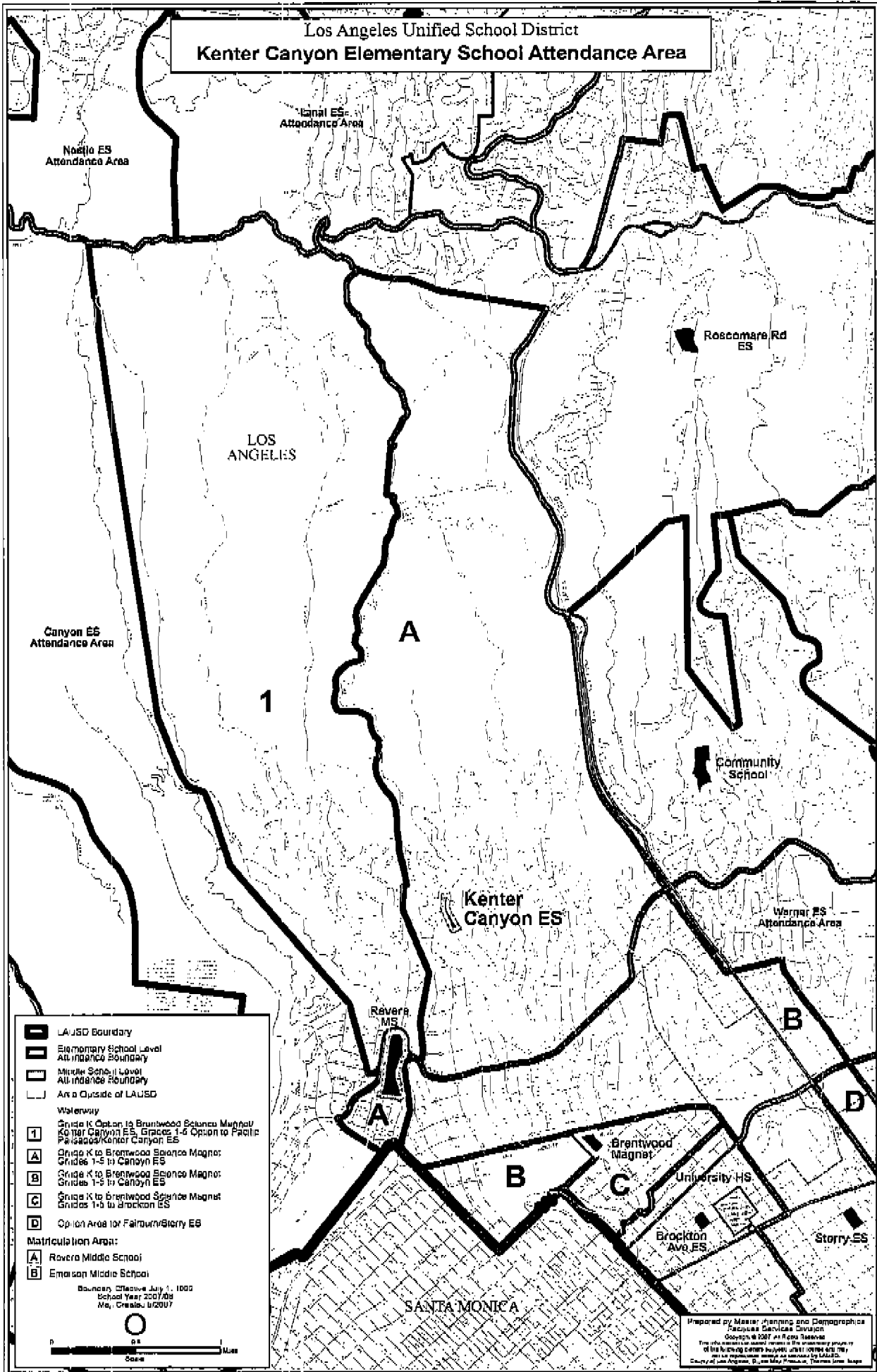

Legend

- LAUSD Boundary
- Elementary School Level Attendance Boundary
- Middle School Level Attendance Boundary
- Area Outside of LAUSD

Waterway

- 1** Grade K Option to Brentwood Science Magnet/Kenter Canyon ES, Grades 1-6 Option to Pacific Palisades/Kenter Canyon ES
- A** Grade K to Brentwood Science Magnet; Grades 1-5 to Canyon ES
- B** Grade K to Brentwood Science Magnet; Grades 1-5 to Canyon ES
- C** Grade K to Brentwood Science Magnet; Grades 1-5 to Brockton ES
- D** Option Area for Fairburn/Storry ES

Matriculation Area:

- A** Revere Middle School
- B** Emerson Middle School

Boundary Effective July 1, 2008
 School Year 2007/08
 Map Created 10/20/07



Scale

Prepared by: Meade Planning and Demographic Services
 Division
 October 2007 as of 10/20/07
 The information shown on this map is the property of Meade Planning and Demographic Services. It may not be reproduced, stored, or transmitted by any means without the prior written permission of Meade Planning and Demographic Services.

Los Angeles Unified School District

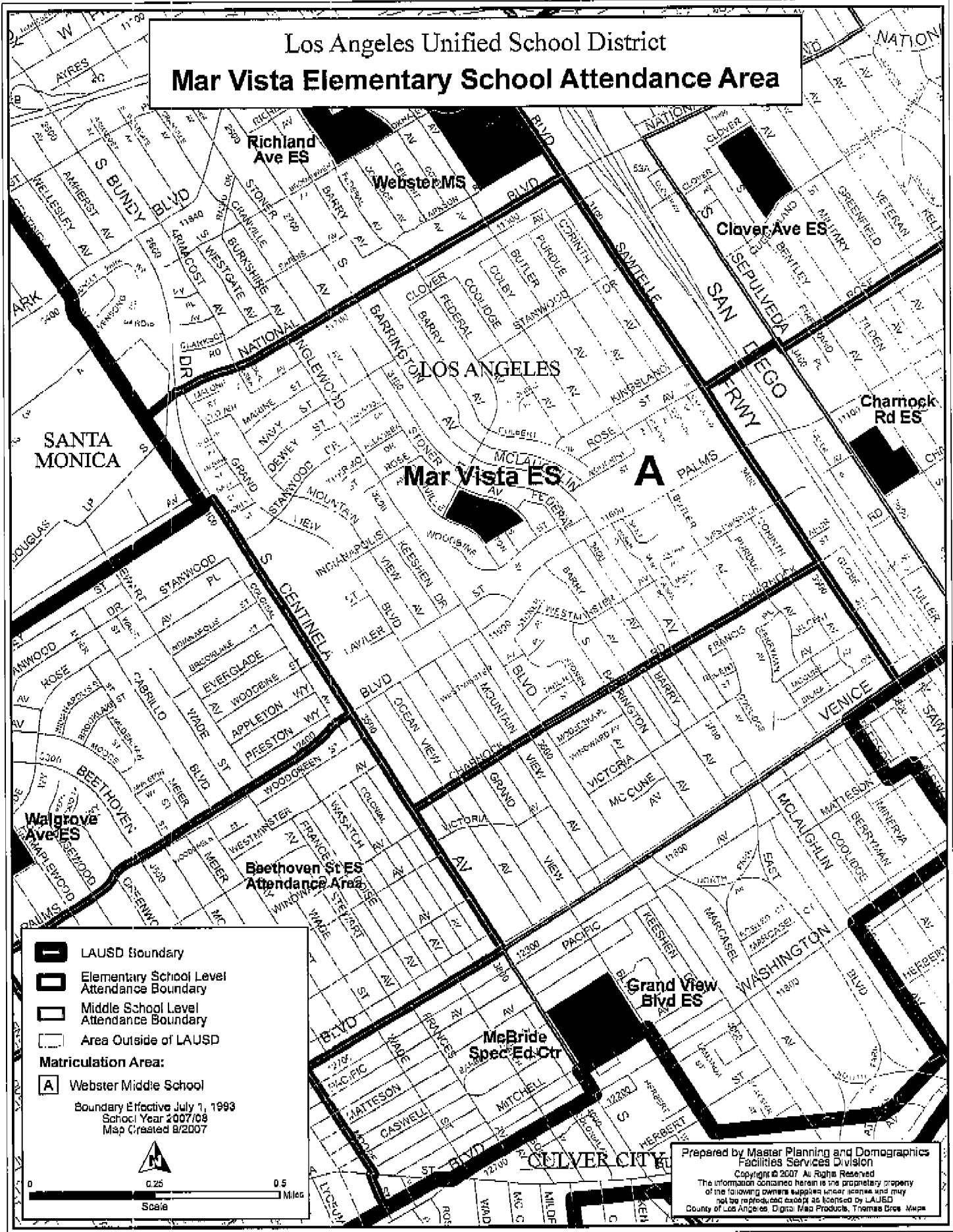
Mar Vista Elementary School Attendance Area

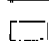

-  LAUSD Boundary
-  Elementary School Level Attendance Boundary
-  Middle School Level Attendance Boundary
-  Area Outside of LAUSD

Matriculation Area:

A Webster Middle School
 Boundary Effective July 1, 1993
 School Year 2007/08
 Map Created 8/2007

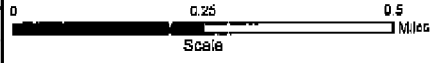

Prepared by Master Planning and Demographics
 Facilities Services Division
 Copyright © 2007. All Rights Reserved.
 The information contained herein is the proprietary property
 of the following owners suppliers under license and may
 not be reproduced except as licensed by LAUSD
 County of Los Angeles, Digital Map Products, Thomas Cree, WMP

Los Angeles Unified School District Beethoven Street Elementary School Attendance Area

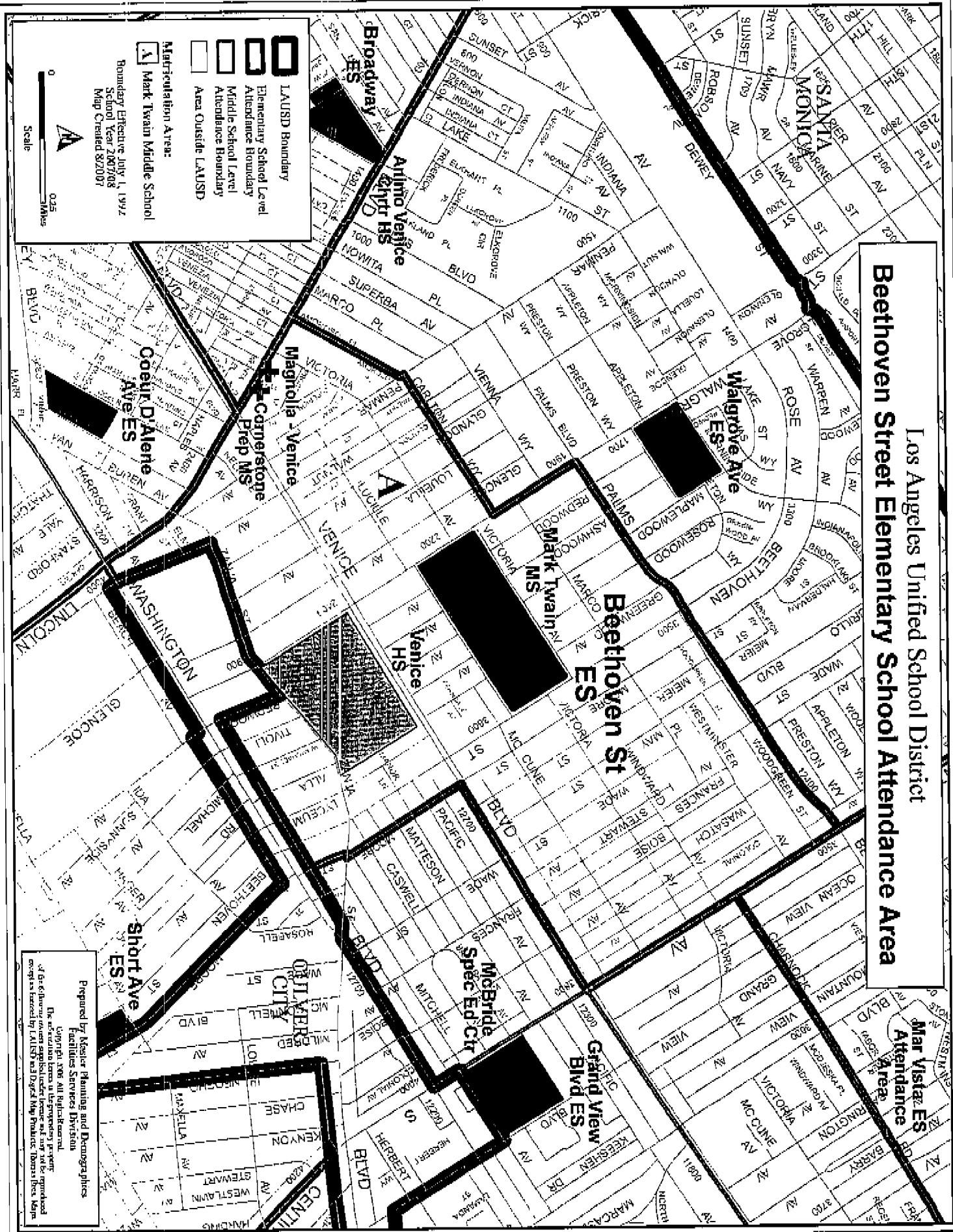

- LAUSD Boundary
 - Elementary School Level
 - Attendance Boundary
 - Middle School Level
 - Attendance Boundary
 - Area Outside LAUSD
- Magnetization Areas:
- Mark Twain Middle School
- Boundary Effective July 1, 1992
 School Year 2007/08
 Map Created 8/2007



Prepared by: Master Planning and Demographics
 Copyright 2008 all rights reserved.
 The information contained in this map and any other information
 supplied is intended for informational purposes only and is not to be reproduced
 except as authorized by LAUSD and Digital Map Products. Owners: Rick Klein

**Los Angeles Unified School District
Warner Avenue Elementary School Attendance Area**

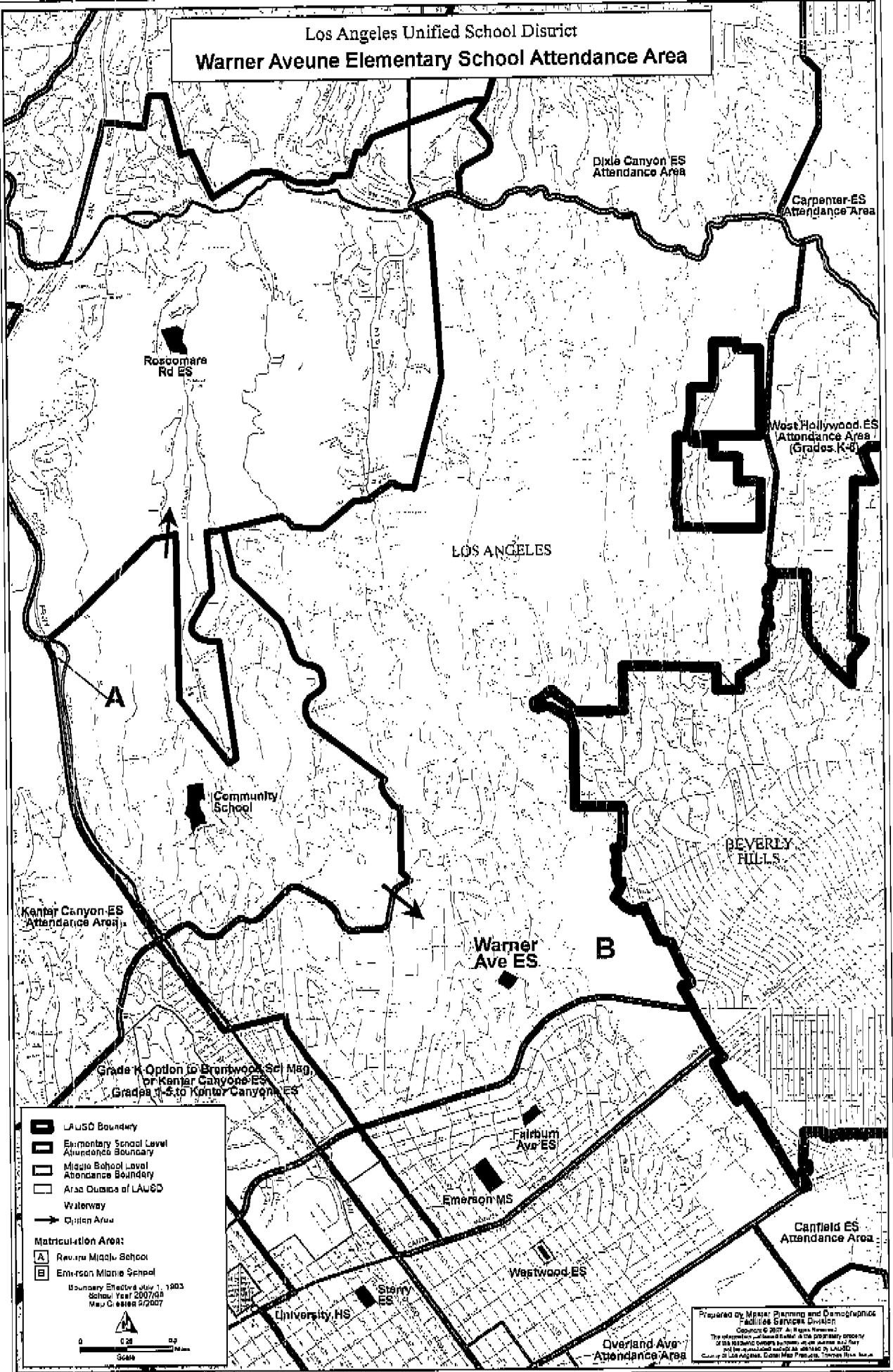

Legend

- LAUSD Boundary
- Elementary School Level Attendance Boundary
- Middle School Level Attendance Boundary
- Area Outside of LAUSD
- Waterway
- Option Area

Matriculation Area:

- Area A: Riverside Middle School, Emerson Middle School
- Area B: Warner Avenue Elementary School

Boundary Effective July 1, 1993
School Year 2007/08
Map C-8888 2/2007

Scale: 0 0.25 0.5 Miles

Prepared by Master Planning and Demographics
Facilities Services Division
January 2007
The information contained herein is the property of the City of Los Angeles and is not to be used for any other purpose without the express written consent of the City of Los Angeles.

Los Angeles Unified School District
Marquez Elementary School Attendance Area

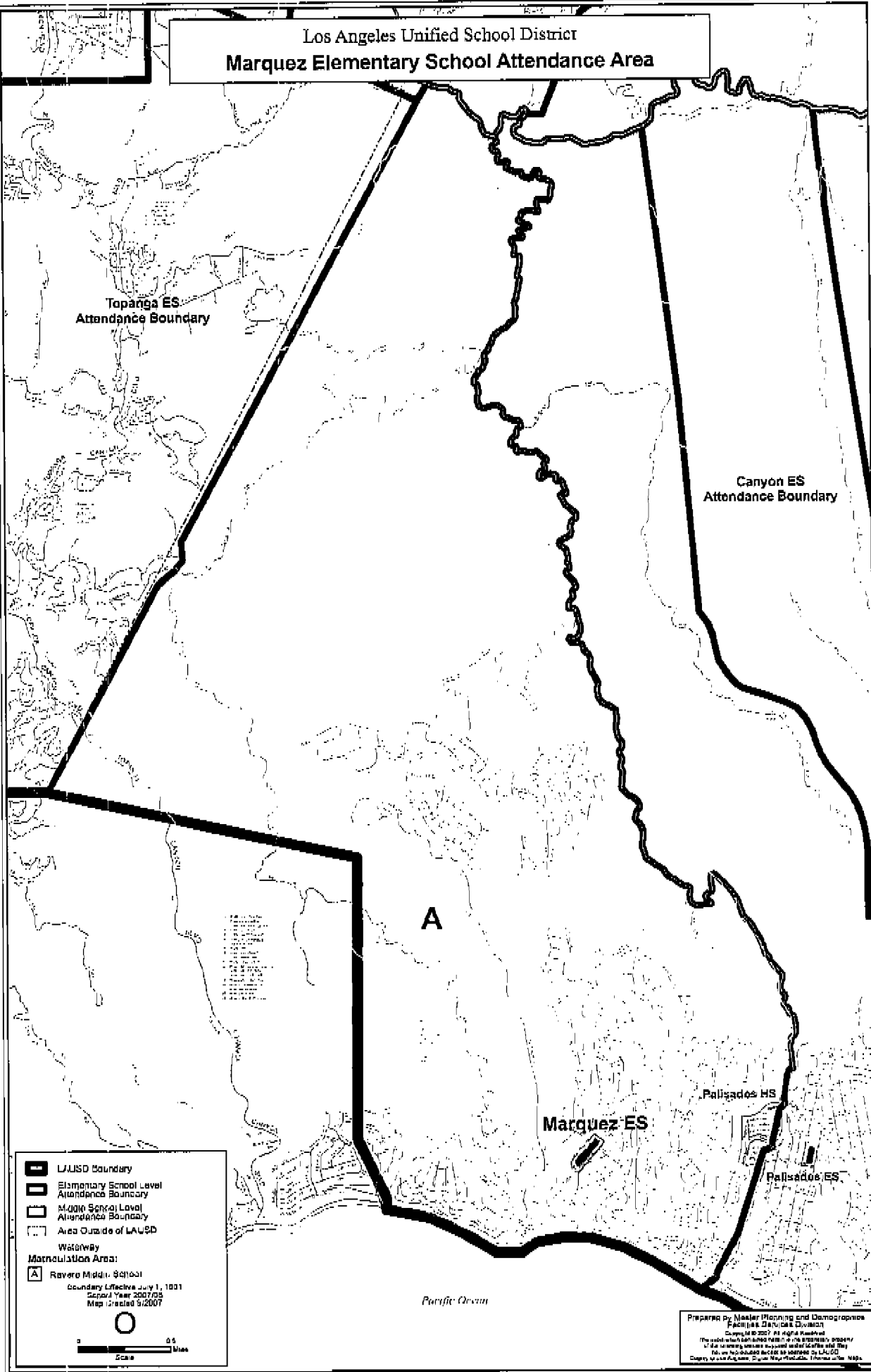

Legend

- LAUSD Boundary
- Elementary School Level Attendance Boundary
- Middle School Level Attendance Boundary
- Area Outside of LAUSD

Waterway

Matriculation Area:

- Revere Middle School
 Boundary Effective July 1, 2001
 School Year 2007/08
 Map Created 9/2007

Scale

Prepared by Nealer Planning and Demographics
 Facilities Services Division
 Copyright © 2007. All Rights Reserved.
 The information contained herein is the property of Nealer Planning and Demographics and is provided under license to LAUSD. No warranty is made by Nealer Planning and Demographics for any use of this information other than that intended by Nealer Planning and Demographics.

Los Angeles Unified School District Pacific Palisades School Attendance Area

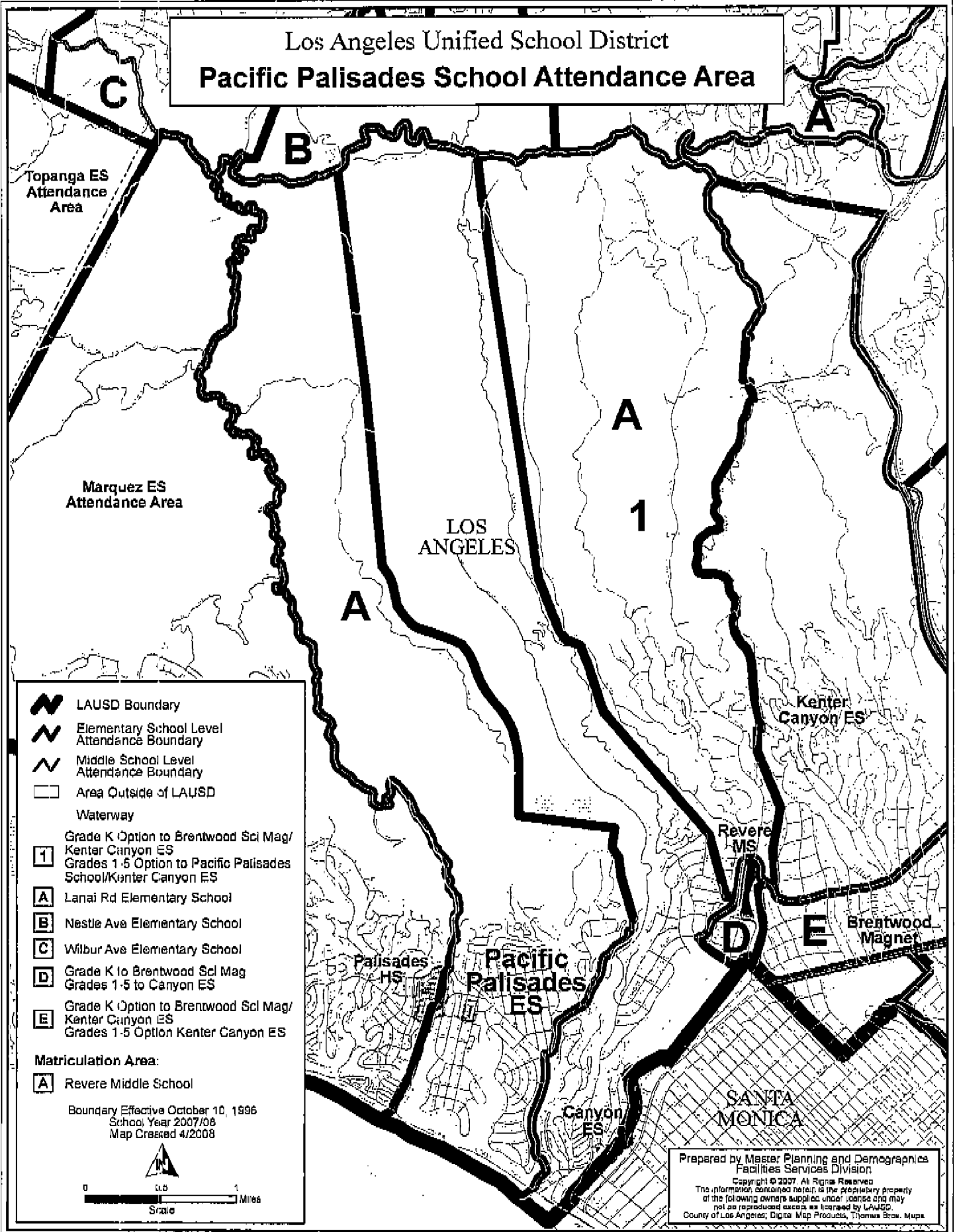

- LAUSD Boundary
- Elementary School Level Attendance Boundary
- Middle School Level Attendance Boundary
- Area Outside of LAUSD

Waterway

- Grade K Option to Brentwood Sci Mag/ Kenter Canyon ES
Grades 1-5 Option to Pacific Palisades School/Kenter Canyon ES
- Lanai Rd Elementary School
- Nestle Ave Elementary School
- Wilbur Ave Elementary School
- Grade K to Brentwood Sci Mag
Grades 1-5 to Canyon ES
- Grade K Option to Brentwood Sci Mag/
Kenter Canyon ES
Grades 1-5 Option Kenter Canyon ES

Matriculation Area:

- Revere Middle School

Boundary Effective October 10, 1996
School Year 2007/08
Map Created 4/2008



Prepared by Master Planning and Demographics
Facilities Services Division
Copyright © 2007. All Rights Reserved.
The information contained herein is the proprietary property
of the following owners supplied under license and may
not be reproduced except as licensed by LAUSD,
County of Los Angeles; Digital Map Products, Thomas Brow Maps